

PC-Based Scale CL8000

Powerful PC based scale that can handle all the works in the retail area freely.



Powerful PC-Based scale that can handle all the works in the retail area freely.

CL8000 PC-Based scale is a powerful PC scale that can handle every work (Weighing, Labeling, Advertising) in the retail area freely. Thanks to its bright, vivid, and easy-to-read display, Customers can be easily focused on retail information and promotion multimedia.

Front Open Printer

The printer opens to the front side, Users can change the paper conveniently even in a small space.

- Labels or Tickets



Convenient Maintenance

CL8000 is designed for easy repair of parts in a printer and SMPS, which need to be maintained more frequently than other parts.

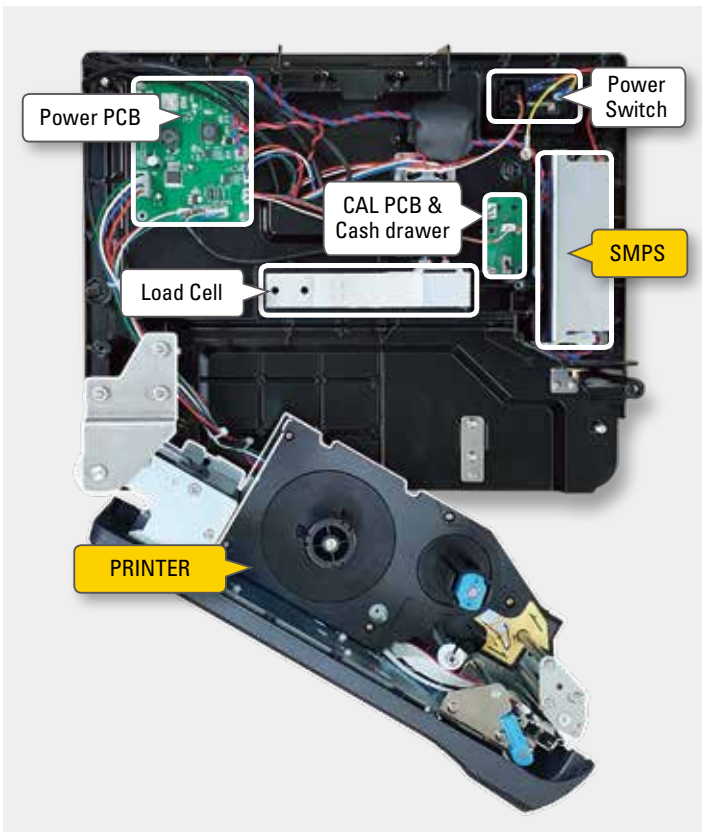

Operator Display

- 15" Touchscreen TFT LCD (PCA type)
- 10.1" Touchscreen TFT LCD (B, U, SU type)



(15" Touchscreen)

(10.1" Touchscreen)

64GB SSD / Unlimited PLU

CL8000 equipped a 64GB solid state drive, which is sufficient storage for the solution.

So, as a label printing scale, CL8000 has practically no limit on the number of PLUs. Product Information such as ingredients, or nutrition facts can also be saved to its PLU without restriction.

Operating System

- Window 10 IoT (OEM ver.)
- Linux / Ubuntu 18.04 (CAS Software Ver.)



Interfaces

- USB x 6, COM x 3-6, LAN x 1, RJ11 x 1



Product Line-Up

CL8000 has 4 different types; PCA, U, B, and SU type.

Customer display of PCA and U type is closed to a customer's sight, so it can catch the customer's eye easily.

Customer display of CL8000-B is placed on the opposite side of its operator display, and the display of CL8000-SU is hanging on the tiny pole. These two types are suitable when the scales are placed on the raised counter.



CAS Software

CAS can also provide retail software for CL8000. With our software, CL8000 can be set as a convenient retail scale without any modification. Its convenient interface can make operators weigh the products easily and handle the scale efficiently.

Also, It can also be compatible with our PC program, CL-Works Pro.

- User screen design
 - Automatic PLU arrangement by its Category
 - Editing PLU directly on the scales, including image, font size, PLU key size
- PLU searching / bookmark function
- Configurable Language / Keyboard Setup
- Remote Support
- Printing labels with True type fonts
- Data Transfer by REST API
 - Transmitting data from an external system to CL8000

CAS Self-Service Software



CAS Label Printing Scale Software



PC-Based Scale CL8000

Specification

Capacity		Max 3/ 6kg	Max 6/ 15kg	Max 15/ 30kg		
Dual Interval	Readability	e=1/2g	e=2/5g	e=5/10g		
	Resolution		1/3,000			
Model		PCA-Type	B-Type	U-Type	SU-Type	
Display	Operator (Front)	Panel	15" Touchscreen TFT LCD	10.1" Touchscreen TFT LCD	10.1" Touchscreen TFT LCD	10.1" Touchscreen TFT LCD
		Touchscreen	Capacitive Touchscreen			
	Resolution	1024x768 (4:3)	1024x600 (17:10)	1024x600 (17:10)	1024x600 (17:10)	1024x600 (17:10)
	Customer (Rear)	Panel	9.7" / 15" TFT LCD	7" TFT LCD	10.1" TFT LCD	10.1" TFT LCD
Resolution		1024x768 (4:3)	1024x600 (17:10)	1024x600 (17:10)	1024x600 (17:10)	
PC	CPU	Intel Celeron J1900 (2.42GHz)				
	Memory	DDR3L 4GB				
	Storage	SSD 64GB				
	Interfaces	USB x 6, COM x 6 LAN x 1, RJ11 x 1, Audio Out x 1	USB x 6, COM x 3, LAN x 1, RJ11 x 1 Audio Out x 1, Audio In x 1			
Labels / Tickets Printer	OS	OEM Version: Window 10 IoT / CAS Software Version: Ubuntu 18.04				
	Type	Direct Thermal Printing				
	Resolution	202 dpi				
	Speed	150mm/sec				
	Print Width	Max. 56mm				
	Paper Length	Max. 65mm				
Print Length	Max. 200mm					
Power	AC 100~240V 50/60Hz, 1.5A (Max. Power Consumption: 120W)					
Platter Size	368mm x 288mm					
Product Size (mm)	399(W) x 447(D) x 631(H)	399(W) x 450(D) x 211(H)	399(W) x 494(D) x 590(H)	399(W) x 494(D) x 303(H)		
Product Weight	16.0kg	10.3kg	12.5kg	11.8kg		
Option	Linerless Printer					

Dimension

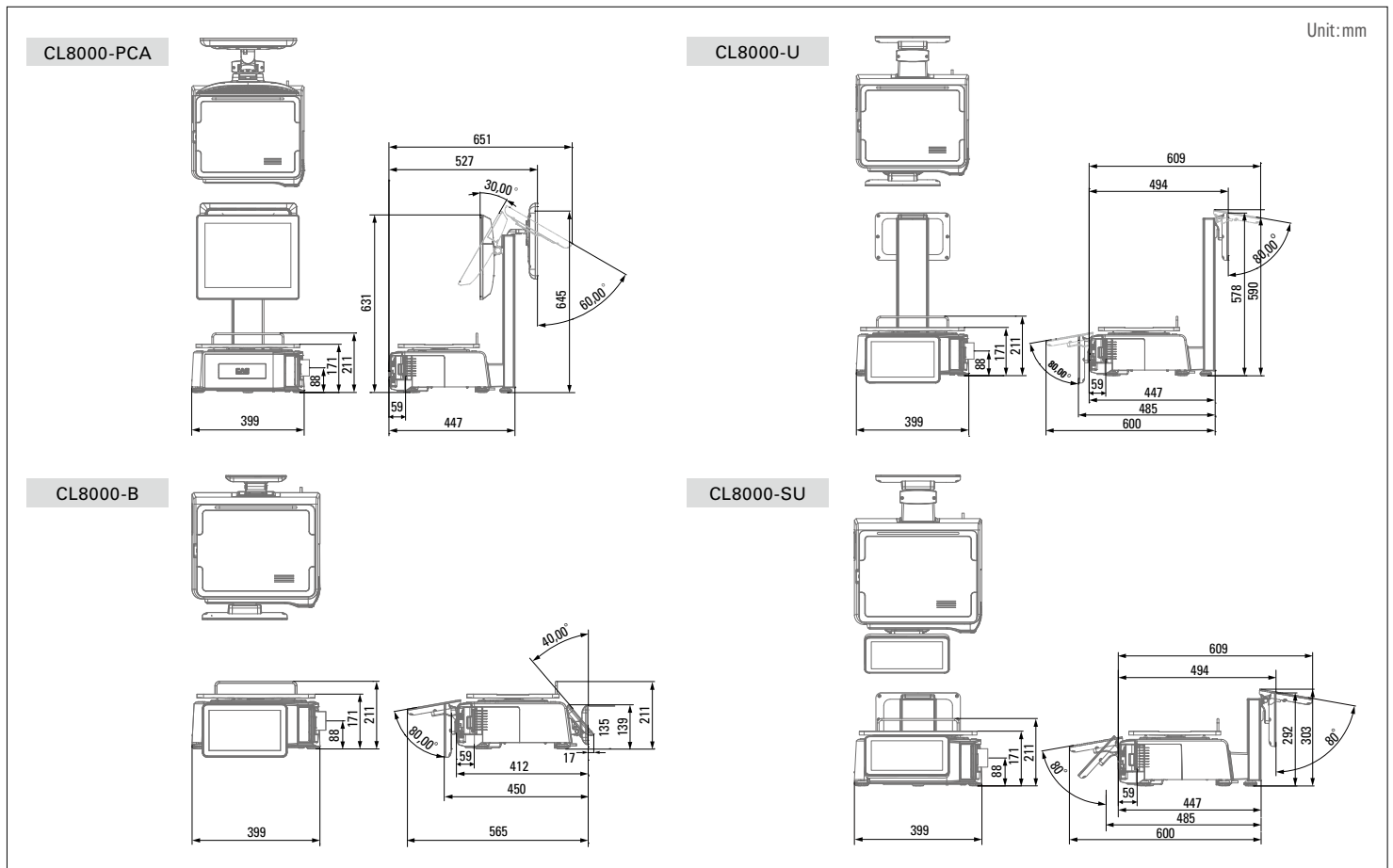

Ver. 2.0_71801202



CAS Global Homepage

CAS CORPORATION

CAS BLDG., 1315, YANGJAE-DAERO
GANGDONG-GU, SEOUL, KOREA
TEL_82 2 2225 3500 / FAX_82 2 475 4668

www.globalcas.com



* Specifications are subject to change without notice improvement.

